

STAT SWABII One-step Drug Test Procedure Card

Allow the test device to reach room temperature [15-30°C (59-86°F)] prior to testing. Do not place anything in the mouth including food, drink, gum, or tobacco products for at least 10 minutes prior to collection of oral fluid specimen.

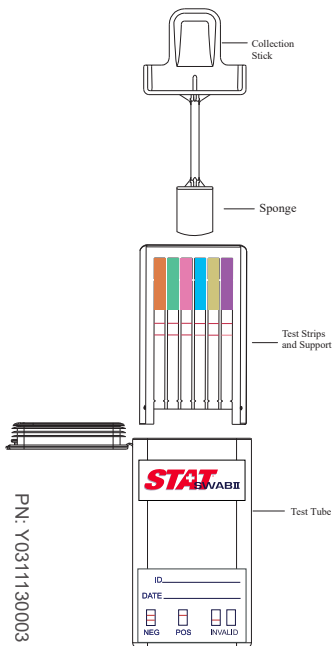

1. Remove the collection stick and test tube from the sealed pouch.
2. Tear off the package of the collection stick. (Step 1)
3. Insert the sponge end of the collection stick into mouth and soak sponge into saliva for 3 minutes. (Note: Time should be longer for people of little saliva. If the amount of saliva pressed into the test tube is not adequate for testing, collect more with another new collection stick and express the saliva into tube again.) (Step 2)
4. Hold the test tube vertically and place the collection stick with saturated sponge into the test tube. Make sure to fit the groove of collection stick onto the guide rail of test tube and press the collection stick to full extent. (Step 3)
5. Press down the lid to close the test tube. Keep the test tube vertically until you begin to read the test results. (Step 4)
6. Read results at 10 minutes. (If there is a label over reading window, peel off the label to read test results.) **Do not read results after 1 hour.** (Step 5)

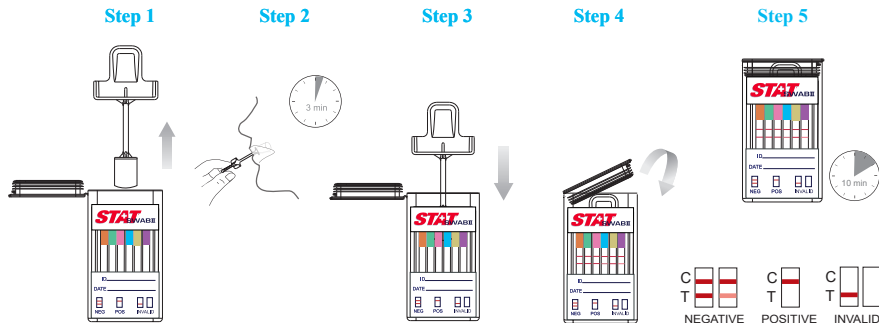

Oral Fluid Drug Screen Device

Oral Fluid Drug Screen Device

Oral Fluid Drug Screen Device