



Micro Distributing

A Diagnostic Distribution Company

CLIA
WAIVED



Product Training

One-Step Cassette Test Device

Diagram of *One-Step* Cassette Test Device

- Easy-to-Use
- Results in minutes
- FDA Approved
- **CLIA Waived for:**
 - AMP, mAMP, OPI, THC, PCP, COC, MDMA
- 13 drugs available in many combinations (10 max)

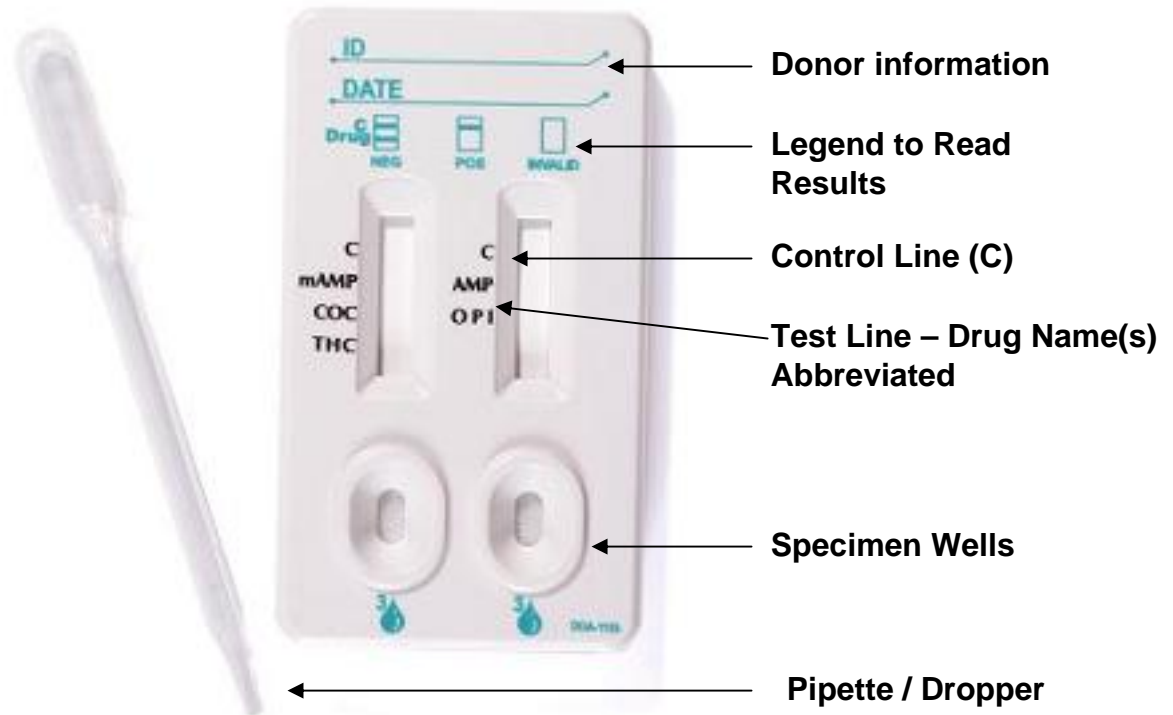

5-Panel Cassette Test shown

General Directions for Storage and Stability

- **Store test device at room temperature (35-77°F or 2-30°C)**
- **Do not freeze kits**
- **Do not use after Expiration Date**
- **If refrigerated or frozen, allow urine specimen to equilibrate to room temperature prior to testing**
- **Remove the test from the sealed pouch and use it as soon as possible**

How to Administer the Test

Test Label:

- Part No.
- Lot No.
- Exp. Date

Sterile
Collection
Cup with
Temperature
Strip

Protective
Gloves

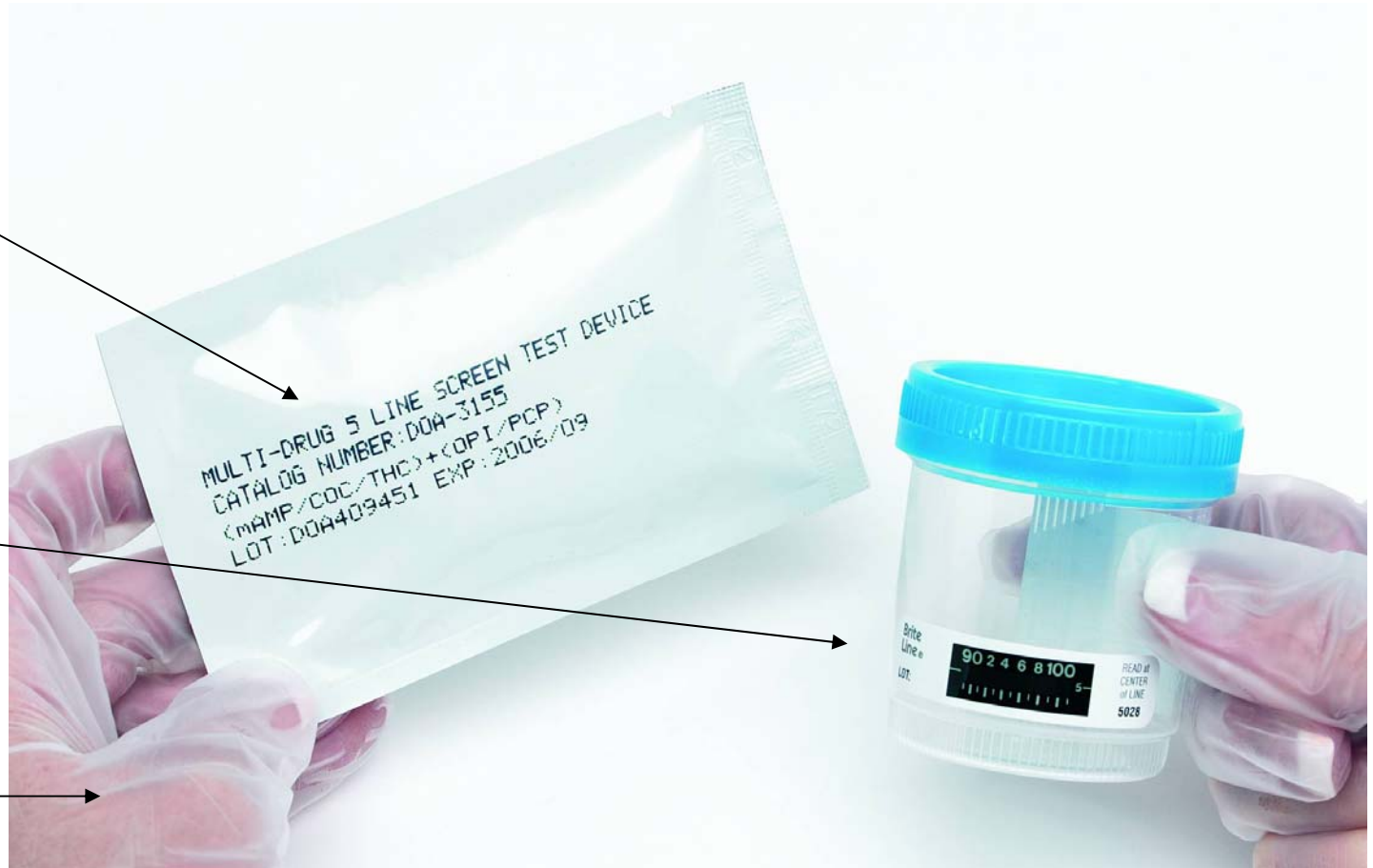

Enter Donor Information on the Collection Cup Label

Give the labeled collection cup to the donor with your specific collection protocol instructions.

Contact us for assistance with Urine Collection Guidelines.

866-933-0964



Enter Donor Information on the Test Device



Prepare to Perform the Test

After the specimen has been collected, check the temperature strip on the collection cup. If temperature is not between 90 - 100 F sample is considered invalid.

Remove the test device and the pipette from the foil pouch



Look for greenish color to appear along the temperature strip

Fill Pipette with Urine Sample

Squeeze the air out of the bulb end of the pipette and immerse in urine sample.

Release hold on bulb while still immersed and let pipette fill with urine sample



Perform the Test

Replace cap

Lay test device on a flat surface

Place 3 drop of urine in each specimen well by squeezing the bulb end of the pipette

Read the results within 2-5 minutes

Results are stable for up to 4 hours



Interpret the Drug Test Results

NEGATIVE: Two lines appear. One red line appears in the control region (C), and another red line appears in the test region (T). A negative result indicates that the drug concentration is below the detectable level.

***NOTE:** The shade of red in the test line region (T) will vary, but it should be considered negative whenever there is even a faint pink line.

POSITIVE: One red line appears in the control region (C). No line appears in the test region (T). A positive result indicates that the drug concentration is above the detectable level.

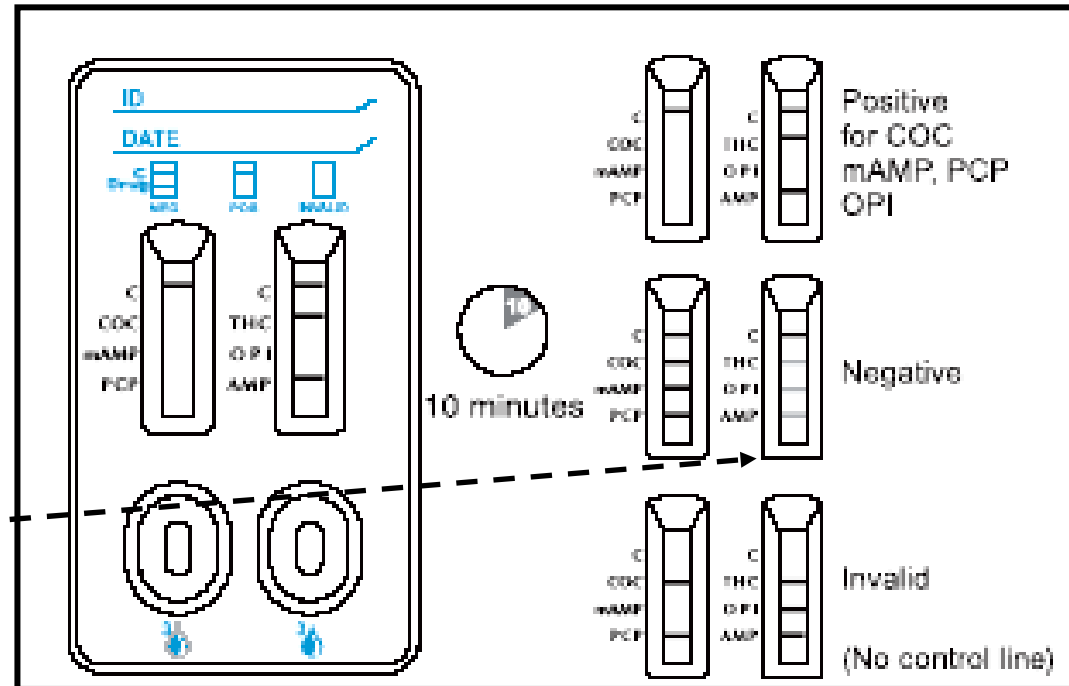

INVALID: Control line fails to appear. Review the procedure and repeat the test using a new test panel. If the problem persists, discontinue using the lot immediately and contact MD.

Example of Actual Test Results

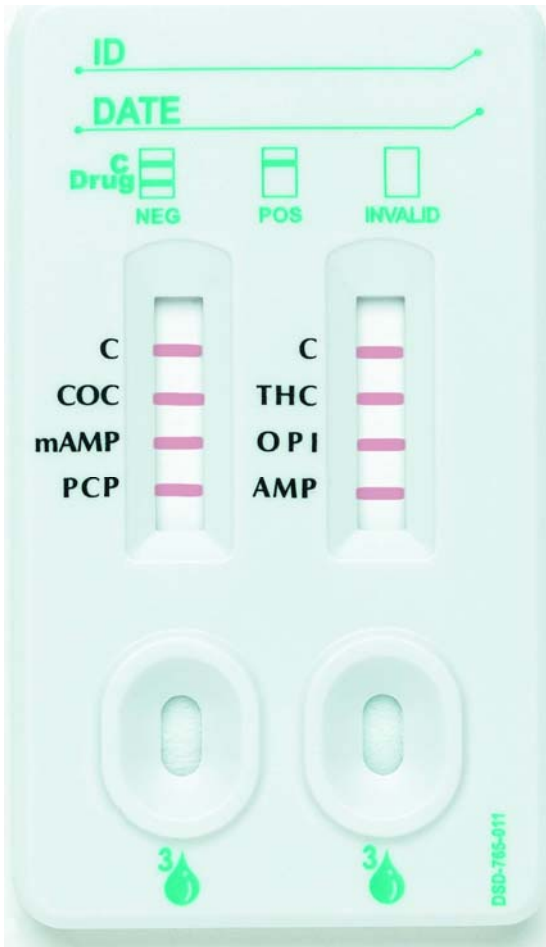

Negative

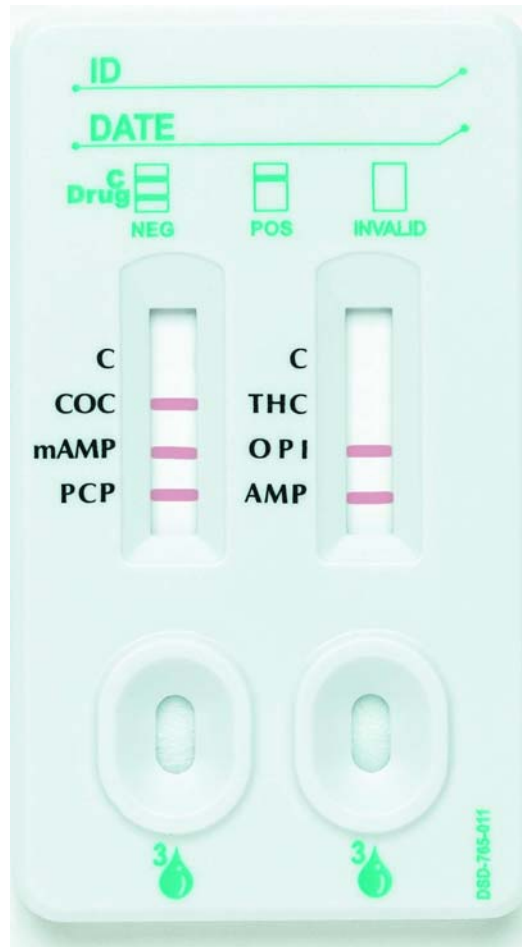

Invalid

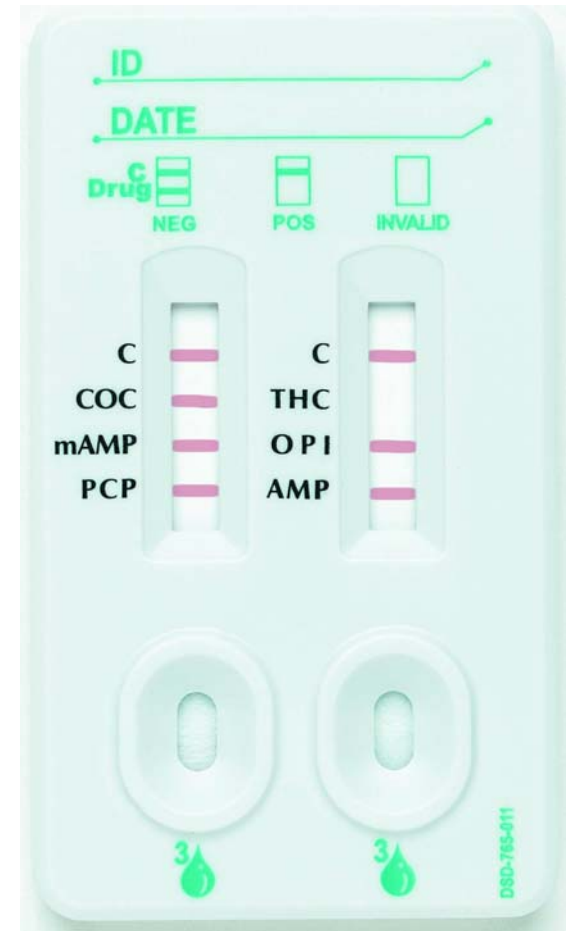

Positive for THC

Drug Test Methodologies

Screening Test: The *One-Step* Cassette Test Device is considered an initial screen and is based on a technology called Enzyme Multiplied Immunoassay Technique (EMIT)

- Provides a Preliminary result
- Based on competitive binding for drug antibodies at specific ng/ML levels.
- Results are Qualitative (eg. presence of a line; yes/no answer)

Confirmation Testing: It is recommended that positive initial screening results be confirmed with a more specific methodology called Gas Chromatography / Mass Spectrometry (GC/MS)

- Considered the “Gold Standard” in drug testing
- Based on the physical and chemical properties of the specific drug or metabolite to be measured by extracting the drug from the urine or saliva and using heat or liquid to cause the metabolites to separate.
- Results are Quantitative (eg. Numeric level reported; 1,438 ng/mL)

[Click Here](#) for more information about Oral Fluid GC/MS Confirmation

ng/ML Cut Off Levels

drug concentration levels required for positive result reporting

Drug	EMIT Screen Level ng/ml	GC/MS Level ng/ml
Amphetamines	*1000	500
Barbiturates	300	200
Benzodiazapines	300	200
Marijuana:	*50	15
Cocaine	*300	150
Methadone	300	200
Methamphetamine	*1000	500
Methaqualone	300	200
Opiates	*2000 / 300	2000
PCP	*25	25
Propoxyphene	300	200

SAMHSA – The Substance Abuse and Mental Health Services Administration established drug testing cut off levels for Federal Workplace Testing. These cut offs have become the “standard” for non-federal workplace testing as well.

Drug Detection Periods

The window of time after taking a drug that it can be detected in urine

Drug	Detection Period
Amphetamines	2-4 days
Barbiturates (phenobarbital – 2 weeks or longer)	3 days
Benzodiazapines	Up to 2 weeks or longer
Marijuana: Infrequent User Chronic User	2-7 days 30 days or longer
Cocaine	2-3 days
Methadone	2-4 days
Methamphetamine	2-4 days
Methaqualone	Up to 10 days
Opiates	2-3 days
PCP	3-8 days; Chronic use up to 30 days
Propoxyphene	3-7 days

Technical Support

24/7 Support Hotline

866-933-0964

or Contact us at

EMAIL: info@micro-distributing.com

WEB: www.micro-distributing.com